

SECTION	1	GENERAL OVERVIEW
	1.1	Introduction
	1.2	The Vixen Modular Concept
	1.3	Guidelines for Wheelchair Prescription

1. GENERAL OVERVIEW OF THE VIXEN FAMILY

1.1 Introduction

The 'Vixen Family' of powered wheelchairs has evolved from previous tried and tested modular designs.

Response to the needs of the *Users* is achieved through close collaboration with, *Rehabilitation Engineers, Occupational Therapists, Industrial Designers and Service, Maintenance and Repair Contractors.*

The 'Vixen Family' comprises of 4 standard models:-

- Vixen – Cub
- Vixen – EPIC
- Vixen – EPIOC
- Vixen – Heavy Duty

Combined with a broad range of *seat options and interchangeable components and accessories* each model allows the clinician and prescription team to tailor the chair to the users specific needs. The settings, options and accessories can be changed, as the user needs change or if the chair is re-issued as a new prescription.

The ease with which servicing and repair work can be carried out also benefits from the modular system of construction.

Standard approved parts can be interchanged thereby limiting the need to hold large stocks of spares.

Equipment such as upholstery, controllers, batteries, motors and chassis and other framework are easily removed for inspection and if necessary replacement.

EPIC = Electrically powered indoor chair

EPIOC = Electrically powered indoor/outdoor chair.

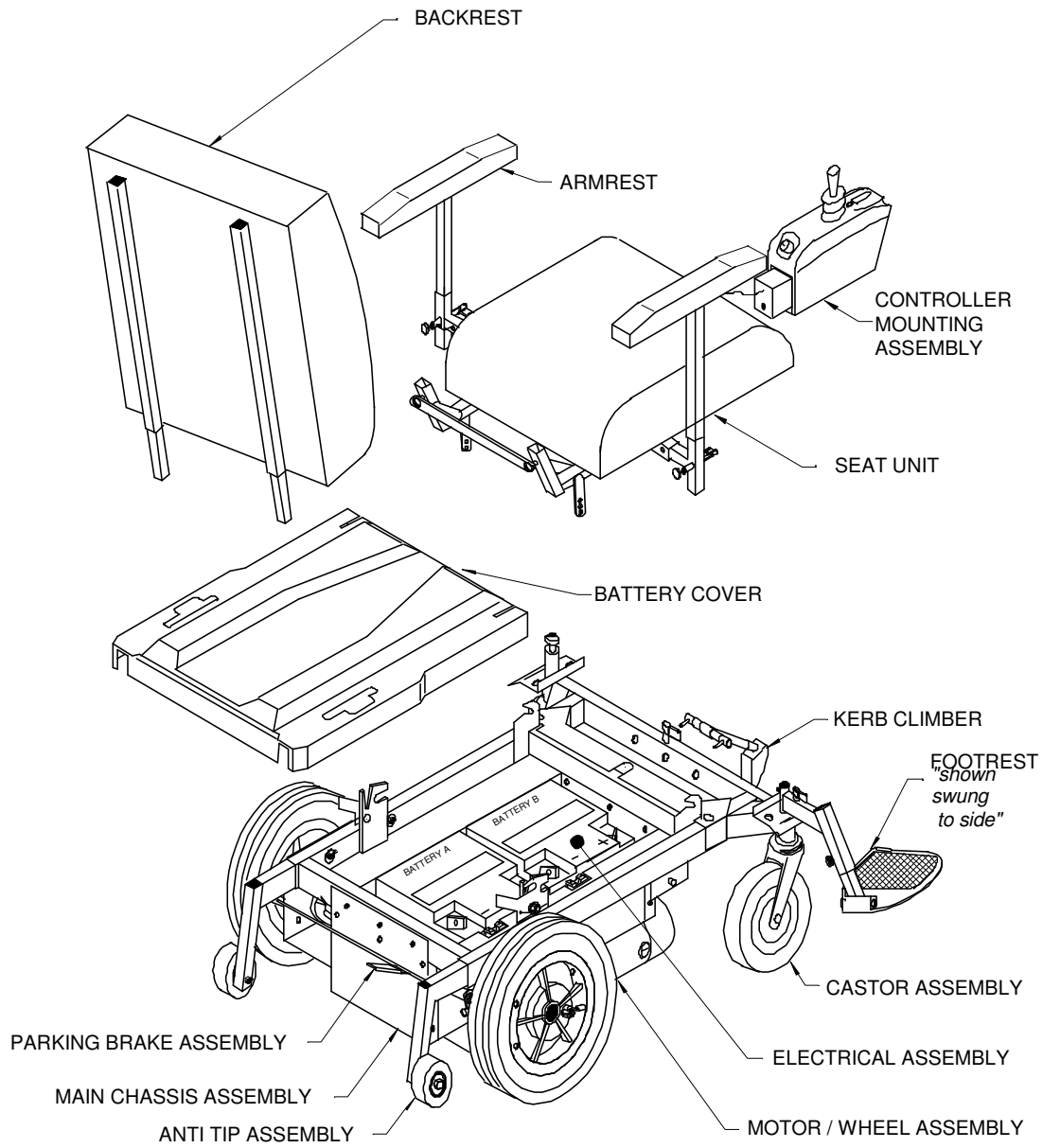

EPIOC GENERAL ASSEMBLY

1.2 The Vixen Modular Concept

Each chair in the Vixen Family comprises a *seat unit* mounted on a separate motorised *chassis unit*.

The seat unit is mounted on the chassis via 4 mounting points, which incorporate simple seat height and angle adjustments.

The chassis unit is of a robust construction with both motors horizontally mounted, a position which affords maximum protection against accidental damage whilst allowing effective air-cooling. The batteries are carried in a channel section between, but isolated from, the motors.

The wheelchairs incorporate a mechanism to disengage clutch. Using this mechanism enables an attendant to push the chair if required.

1.3 Prescription Guidelines

Chair Types

Vixen Cub (EPIC)

Designed for use in confined spaces such as found in the users home, on level surfaces, with 2mph speed limit. Maximum user weight is 80kg (176lb)
May be used on level surfaces outdoors in domestic or similar environments. Not designed for 'street use'.

The Vixen EPIC (Short Wheel Base. SWB)

Designed for use in the same type of environment as the Vixen Cub and the same 2mph speed limit. It is not intended for general outdoor use. It has a maximum kerb/threshold climbing height of 1" (25mm), maximum gradient 1:5 (12%) dependant on user weight and disability. Maximum user weight 100kg (224lbs).

The Vixen EPIOC (Long Wheel Base. LWB)

Designed for indoor/outdoor use, with a speed limit of 4mph. It has 8" castors for greater kerb/threshold climbing capabilities 3" (75mm) or up to 4" (100mm) depending on experience and capability of the user. It has a larger wheelbase and track for greater stability. Maximum user weight 115kgs (252lbs).

The Vixen Heavy Duty (EPIOC)

Is designed for the bigger user having a maximum user weight of 160kg (25 stones). Intended for indoor/outdoor use with 4mph speed limit.

Having decided whether the chair is for Indoor or Outdoor use, if the chair is to be User, Attendant or Dual operated, the prescription process must be consider the size and other characteristics of the user/carer. The need for a non-standard chair must be assessed e.g. special seat systems, leg/footrests etc.

Chassis Units

There are four chassis units

SWB (Short wheel base + 5" castors)	Vixen Cub & Vixen EPIC
LWB (Long wheel base + 8" castors)	Vixen EPIOC
Heavy Duty (Heavy gauge long wheel base + 8" castors)	Vixen Heavy Duty
Extended Chassis (Heavy gauge with 5" extra length + 8" castors)	Vixen Tilt in Space

Seat Units

Seat units are available in a range of sizes for each model to suit the individual prescription.

The Vixen Cub seat unit has a Low, (standard) or High, (option) mounting brackets for the seat frame, and the backrest is bolted to the seat frame in 1 of 3 positions; for seat depth adjustment.

The modular seat units are designed to accommodate a wide range of sizes, allowing for accurate seat prescription.

The seat depth on the EPIOC & Heavy Duty seats can be extended by 3" (75mm) with the seat extension pad and brackets.

Specialised Seat Options

Side Pads (to reduce seat width) and a Headrest are available as accessories.

Standard seat units for the EPIC, EPIOC and Heavy Duty up to 24" (610mm) models are fitted with a detachable backrest.

In addition, a Backrest Extension, Headrest and Seat Extensions are available as accessories.

In addition to the range of seat sizes and types available as standard, variations to meet special needs may also be accommodated. These can range from 'combinations' of standard options to one-off design specials to allow the fitting of specialist seat systems
e.g. Matrix Seats, Jay Products, Roho Products, gel cushions etc.

Frame Finish and Upholstery Type

The frame finish is a standard black across the whole range. The standard upholstery is black and ash. Different colour upholstery may be available as a cost option.

Electrical Control Systems

In the case of NHS Supplies Contracts, any chair may be supplied with or without batteries, controllers and chargers.

Both PG Drives Technology and Dynamics Europe controllers are available as standard equipment.

Attendant Control and Dual Control systems can also be fitted as a cost option

Note

Seating options, controller configurations and mountings that are special to the client's needs are readily accommodated, and should be clearly described on the order/prescription form.

When the specifications have been discussed and confirmed, written quotations will be provided on request.